

USE THIS INSERT INSTEAD OF PAGES 6-10 IN THE OWNER'S MANUAL

BELOW COUNTER INSTALLATION

This installation uses a separate, counter-mounted Auxiliary Faucet. With the eSpring™ Water Purifier below the counter, this installation allows maximum use of counter space, with no visible tubing.

NOTE: You will need an electrical outlet to plug in the power adapter. If you need to install a new outlet, it must be installed by a licensed or certified electrician according to Federal, Provincial, State, Municipal and local laws. This outlet must be powered continuously for the Water Purifier to function properly. In case of a power outage, see p. 13 in the manual.

BEFORE INSTALLING THE AUXILIARY FAUCET

Cold water plumbing must be modified to provide a $\frac{3}{8}$ " Outer Diameter (OD) x $\frac{1}{4}$ " Inner Diameter (ID) tubing (plastic or metal) for connection to the Auxiliary Faucet (Fig. 1).

RECOMMENDATIONS

- Hire a plumber if you do not feel comfortable modifying the plumbing and installing the faucet.**
- You will need to know what type and size of tubing or piping is between the cold water supply line and the kitchen faucet. Take a digital picture of your cold water supply plumbing to use as a guide in the hardware store to purchase the appropriate parts for installation.
- Install a tee in your cold water supply and a separate shut-off valve to the tee before connection of the Auxiliary Faucet (Fig.1). This will allow rinsing and cleaning of the Water Purifier during Cartridge changes.
 - All fittings and valves must be approved for use in drinking water applications.
 - You must purchase plastic ferrules when connecting plastic tubes to metal compression fittings (which come with metal ferrules for connection to metal pipe).

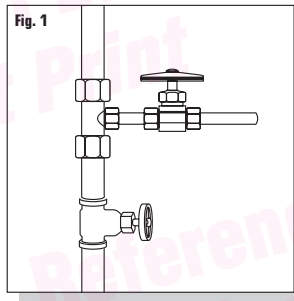

Residents of Massachusetts, please adhere to the State of Massachusetts Plumbing Codes. Use a licensed plumber for installation.

REVIEW ALL INSTALLATION INSTRUCTIONS TO BE SURE YOU HAVE ALL PARTS AND TOOLS PRIOR TO INSTALLATION.

Auxiliary Faucet Components (Fig. 2):

- Auxiliary Faucet spout
- Auxiliary Faucet body with red, green and blue tubes, foam gasket and wing nut
- Connector with flow controller.

NOTE: Connector must be used for all installations.

Tools Needed (not included):

- Pen
- Open-end wrenches $\frac{3}{8}$ " (10mm) and $\frac{7}{8}$ " (22mm) or an adjustable crescent wrench

Optional Tools:

- Drill
- Hole Saw $1\frac{1}{4}$ " (32mm) – $1\frac{1}{2}$ " (38mm)

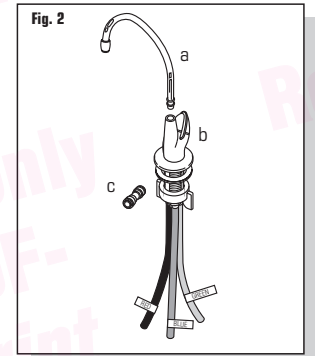

PREPARING FOR INSTALLATION

1. a. **Lay** the red tube and the green tube on the top of the diagram one at a time. Lay the blue tube on the bottom and use a pen to **mark** them at the arrows (Fig. 3).
- b. Use a ruler or **lay** the tube from the cold water supply on the top of this diagram and **mark** a line at $\frac{3}{4}$ " (18mm) or at the arrow (Fig. 3).

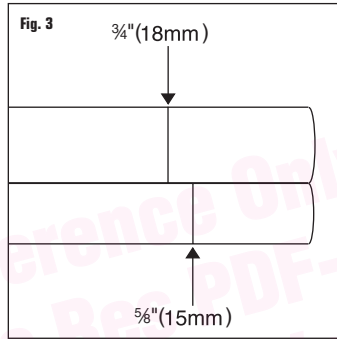

2. **Select** a location for the Auxiliary Faucet. There may already be an extra, capped hole in your sink's ledge for a sprayer, soap dispenser or extra faucet that can be used for mounting your Auxiliary Faucet. If you are removing the connected sprayer, it will need to be sealed properly. (See local plumbing store for assistance.)
3. If you need to drill a new hole, it must be between $1 \frac{1}{4}$ " (32mm) and $1 \frac{1}{2}$ " (38mm) in diameter, less than $5 \frac{1}{2}$ " (140 mm) from the sink basin and at least $1 \frac{1}{4}$ " (32mm) from the wall. Before drilling, make sure that you have sufficient clearance below the sink or countertop to accommodate the faucet and allow you to make connections to the eSpring™ Water Purifier.

NOTE: For solid countertops it is recommended to use a very sharp bi-blade hole saw and start by making a pilot hole. If you have a porcelain/ceramic sink or a tile countertop, it is recommended to seek professional assistance for proper drilling.

WARNING: Due to the possibility of shock or electrocution, use extreme care when operating an electric power drill or other power tools around the sink. Make sure that no part of you or the drill comes into contact with water or moisture at any time.

INSTALLING THE FAUCET

1. **Remove** the caps from both ends of the spout. (Fig. 4).

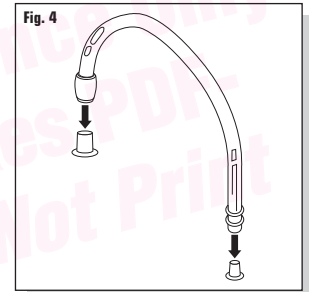

2. **Press** faucet spout into the main body (Fig. 5).

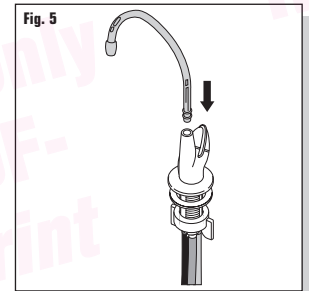

3. **Unscrew** to remove the wing nut while keeping the foam gasket against the faucet body (Fig. 6).

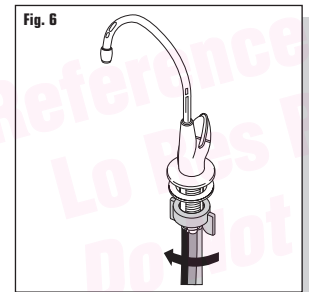

4. Holding the foam gasket in place, **lower** the Auxiliary Faucet stem and tubes through the hole in the sink ledge or counter (Fig. 7).

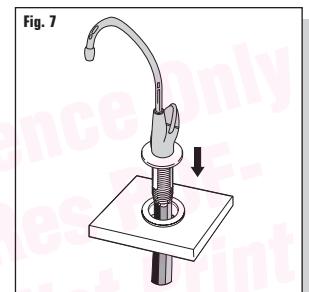

5. With an assistant **holding** the faucet in place, **reach** up from below the counter and **slide** the wing nut onto the threaded faucet. **Position** the faucet in the desired orientation and **tighten** the wing nut to secure the faucet in place (Fig. 8).

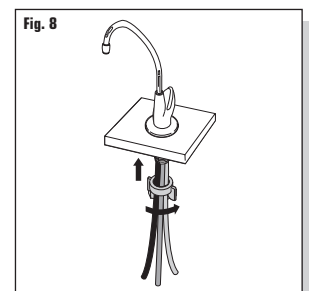

6. **Remove** the Top Shroud (Fig. 9).

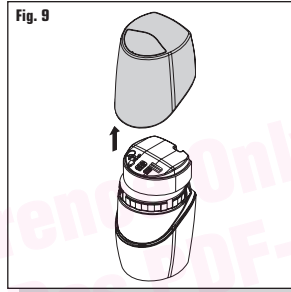

7. **Remove the** Electronic Module (Fig. 10).

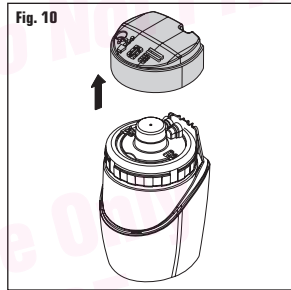

8. **Insert** the green and blue tubes attached to the Auxiliary Faucet into their proper locations on the Bracket (Fig. 11 & 12).

NOTE: You may feel resistance before the tubes are fully installed. Ensure the tube is fully pushed in until it meets the mark or the marks disappear as a check on each of the tube connections in steps 8 -10.

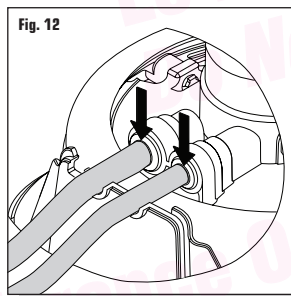
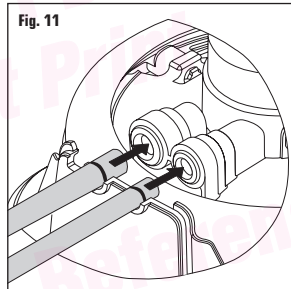

9. Connect the tube from the cold water supply to the screen side of the Connector (Fig. 13).

NOTE: You must use the supplied Connector with flow controller (Fig. 2, part c) between the valve at the water supply and the eSpring™ Auxiliary Faucet.

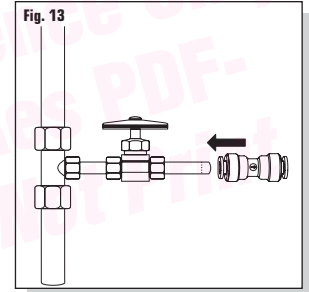

10. Insert the red tube attached to the Auxiliary Faucet into the opposite end of the Connector (Fig. 14).

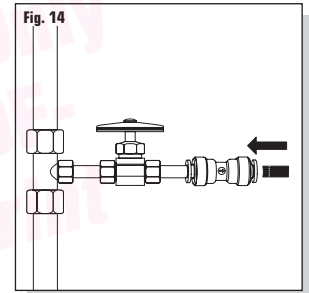

11. **Open** the Auxiliary Faucet (Fig. 15).

12. **Open** the water supply shut-off valve to start water flowing through the Water Purifier.

NOTE: It will take a short time for water to saturate the Cartridge and flow from the faucet. Flush for 5 minutes to remove air pockets and carbon dust. It may take 5-15 minutes to clear.

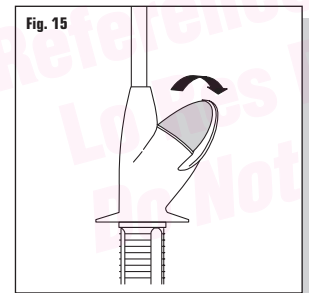

13. **Turn off** the Auxiliary Faucet and check for any signs of leakage at all tubing connections (Fig. 16). If there is leaking or bubbling, refer to Troubleshooting in the manual (p. 12).

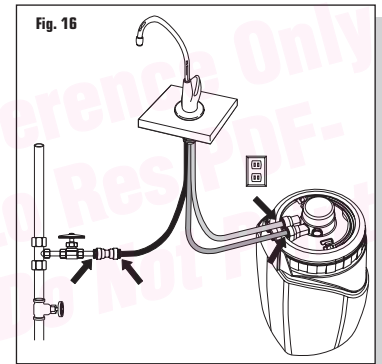

COMPLETING THE INSTALLATION

1. **Insert** Power Adapter into Electronic Module (Fig. 17).

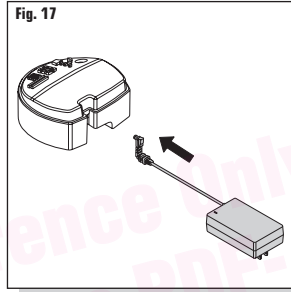

2. **Replace** the Electronic Module (Fig. 18).

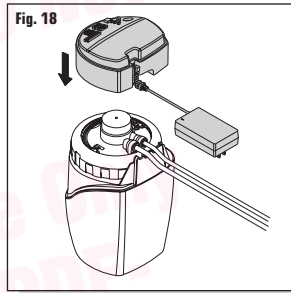

3. **Push** cord strain relief into notch on Base Housing (Fig. 19).

NOTE: Make sure the tubes are in the notches on the back of the Base Housing.

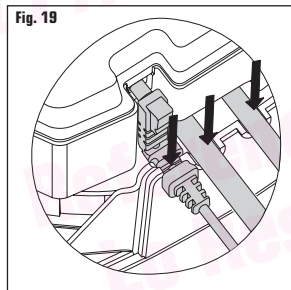

4. **Store** the removal tool for future use (Fig. 20).

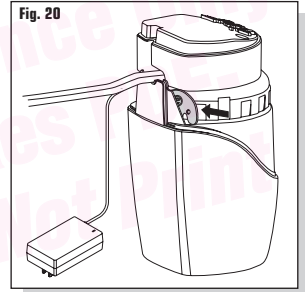

5. **Place** the Top Shroud onto Base Housing (Fig. 21).

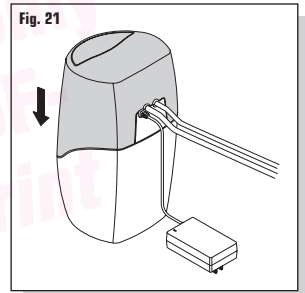

6. **Plug** the Power Adapter into the wall outlet (Fig. 22).

7. **Wait** for monitor to signal with a beep. This may take 30 seconds.

8. **Open** the Auxiliary Faucet to run water through the Water Purifier. Make sure the display has a blue cup. If not, refer to Troubleshooting in the manual, Auditory Warnings (p. 13).

